

THIS COPY IS PROVIDED ON A RESTRICTED BASIS AND IS NOT TO BE USED IN ANY WAY DETRIMENTAL TO THE INTERESTS OF PANDUIT CORP.

PANDUIT P/N	WEIGHT
CFFPR1**	.10 LB/10 PCS (44.8 g/10 PCS)

NOTES:

- SEE CURRENT CATALOG FOR ADDITIONAL PART NUMBER SUFFIXES TO INDICATE COLOR AND OR PACKAGE QUANTITY.
- SEE CATALOG FOR COMPLETE LIST OF PARTS APPLICABLE FOR USE WITH THIS PART.
- DIMENSIONS IN PARENTHESES ARE IN METRIC.
- PART INCLUDES (1) PAINTED #4 X 3/8" MOUNTING SCREW.

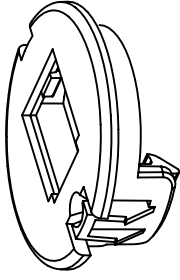
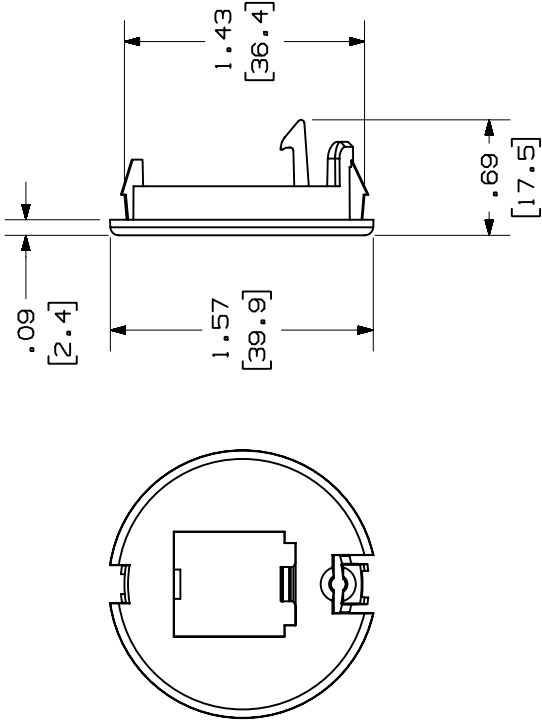

CAD FILENAME/LAYERS

M00785BA_DC_04A.PRT

PANDUIT		CORP. TINLEY PARK, ILLINOIS	
BRAZIL FURNITURE FACEPLATE (CFFPR1**) CUSTOMER DRAWING			
UNLESS OTHERWISE SPECIFIED, DIMENSIONAL TOLERANCES ARE: (.XX) ± .03 (1.8) ANGLES ± (.X) ± (.XXX) ± .010 (.3) (.XX) ± .03 (1.8) ANGLES ±		UNLESS OTHERWISE SPECIFIED, ALL DIMENSIONS ARE GIVEN IN INCHES, THIRD ANGLE PROJECTION.	
DRAWN BY	JSP	MAT'L	NONE
DATE	11-9-99	DRAWING NO.	00785-02
CHECKED BY		SIZE	A
REV	DATE	BY	CHK
R	11-9-99	JSP	
DESCRIPTION		ECN	SUP
RELEASED TO PRODUCTION.		00785-02	
CHK	CUST		